

Protective Cover & Torque Arm Dimensions

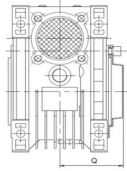

Protective Cover

	30	40	50	63	75	90	110	130	150
Q	NA	1.97	2.28	2.72	2.91	3.39	3.7	4.02	4.45
I	3.35	3.94	3.94	5.91	7.87	7.87	9.84	9.84	9.84
IA	0.94	1.24	1.52	1.93	1.87	2.26	2.44	2.72	3.31
IL	0.31	0.39	0.39	0.39	0.79	0.79	0.98	0.98	0.98
IR	0.59	0.71	0.71	0.71	1.18	1.18	1.38	1.38	1.38
IW	0.55	0.55	0.55	0.55	0.98	0.98	1.18	1.18	1.18

Baseplate Dimensions

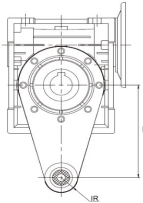

Torque Arm

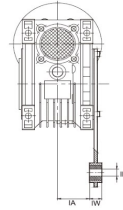

	30	40-A	40-B	50	63-A	63-B	75	90
A	4.38	4.38	5.75	6.38	7.06	8	8.44	9.5
B	3.31	3.31	4.5	4.69	4.88	5.25	5.88	6.13
C	0.34	0.34	0.41	0.5	0.5	0.5	0.5	0.5
DA	2.25	2.65	2.75	3	3.5	3.68	4	4.63
DB	3.43	4.22	4.32	4.97	5.97	6.16	6.95	8.17
T	0.68	0.68	0.78	0.64	0.66	0.85	0.61	0.57

Baseplate Competitor Cross Reference

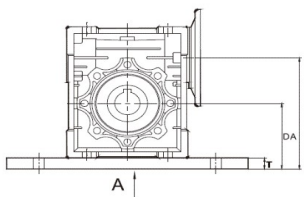

Baseplate

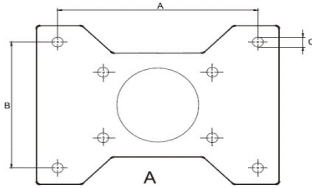

Size	Baldor 900	Boston	Browning/Morse	Grove Gear	Ohio	Dodge	Sterling
30	913	713	133	1133	2133	133	133
040-A	913	713	133	1133	2133	133	133
040-B	918	718	175	1175	2175	175	175
50	921	721	206	1206	2206	200	206
063-A	924	724	237	1238	2238	N/A	237
063-B	924	726	262	1262	2262	262	262
75	932	N/A	300	1300	2300	N/A	300
90	N/A	732	325	1325	2325	350	325