

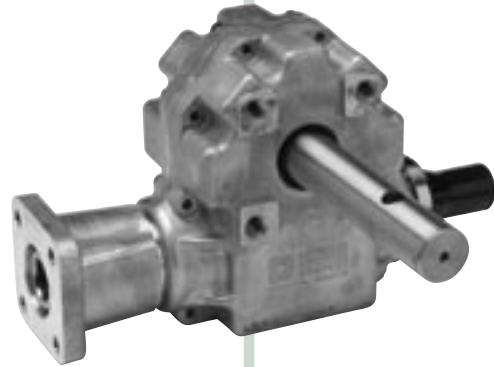

V210 Series



Features:

- Two-piece aluminum housing for high strength, corrosion resistance and thermal capacity.
- Precision machined for exact gear mesh and bearing preload.
- Standard ratios are offered in 5:1, 10:1 and 20:1— left and right hand
- 1" input or hydraulic motor input
- 1.25" output is standard
- Tapered roller bearings provide increased load capacity and bearing life
- Serviced with 85W140 gear lubricant, run and leak tested before shipment
- The V Series weighs approximately 20/25 lbs. including 14 oz of lubricant

Ratio	Gear Design	Input RPM				
			100	400	1200	
5:1	4 Thread Worm 20 Tooth Bronze Gear	Mech.	Input HP	0.91	2.86	5.08
			Output Torque*	2242	1881	1168
			Input kW	0.68	2.13	3.79
			Output Torque**	253	213	132
		Thermal	Input HP	NA	1.51	2.02
			Output Torque*	NA	938	437
			Input kW	NA	1.13	1.51
			Output Torque**	NA	106	49
10:1	2 Thread Worm 20 Tooth Bronze Gear	Mech.	Input HP	0.58	1.96	3.02
			Output Torque*	2559	2161	1361
			Input kW	0.43	1.46	2.25
			Output Torque**	289	244	154
		Thermal	Input HP	NA	0.98	1.36
			Output Torque*	NA	1132	572
			Input kW	NA	0.73	1.01
			Output Torque**	NA	128	65
20:1	1 Thread Worm 20 Tooth Bronze Gear	Mech.	Input HP	0.40	1.15	1.90
			Output Torque*	2789	2360	1492
			Input kW	0.30	.86	1.42
			Output Torque**	315	267	169
		Thermal	Input HP	NA	0.54	0.72
			Output Torque*	NA	1025	526
			Input kW	NA	0.40	0.54
			Output Torque**	NA	116	59

*Torque measured in inch-lbs **Torque measured in N-m

Contact Superior Gearbox for your special requirements.

